

PRODUCT DESCRIPTION

- » According to DIN 6319G
- » Especially suitable for clamping across the slot of a clamp due to the large diameter

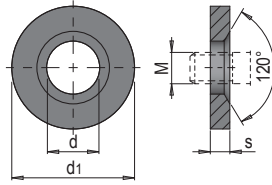

d	d1	s	M	No.	EUR
9.6	24	5	M8	HWS 9019/ 8	<>
12	30	5	M10	HWS 9019/10	<>
14.2	36	6	M12	HWS 9019/12	<>
19	44	7	M16	HWS 9019/16	<>
23.2	50	8	M20	HWS 9019/20	<>

