

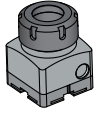





## DESCRIZIONE DEL PRODOTTO

- » Elementi di riferimento originali
- » Preparato per codificare chip



|   | Contenuto     | Pz. | N°                | EUR |
|---|---------------|-----|-------------------|-----|
|    | HER 1232/ER32 | 1   | HER 1232/ER32/SET | < > |
|    | HER 1910/ 1   | 1   |                   |     |
|    | Ø 3           | 1   |                   |     |
|   | Ø 4           | 1   |                   |     |
|   | Ø 5           | 1   |                   |     |
|   | Ø 6           | 1   |                   |     |
|   | Ø 7           | 1   |                   |     |
|   | Ø 8           | 1   |                   |     |
|   | Ø 9           | 1   |                   |     |
|   | Ø 10          | 1   |                   |     |
|   | Ø 11          | 1   |                   |     |
|   | Ø 12          | 1   |                   |     |
|   | Ø 13          | 1   |                   |     |
|   | Ø 14          | 1   |                   |     |
|   | Ø 15          | 1   |                   |     |
|   | Ø 16          | 1   |                   |     |
| Ø 17  | 1             |     |                   |     |
| Ø 18  | 1             |     |                   |     |
| Ø 19  | 1             |     |                   |     |
| Ø 20  | 1             |     |                   |     |
|  | Chiave ER32   | 1   |                   |     |
|  | HER 1839/ER32 | 1   |                   |     |



## DESCRIZIONE DEL PRODOTTO

- » Preparato per codificare chip
- » Elementi di riferimento originali

## MATERIALE

- » 1.2083, temprato

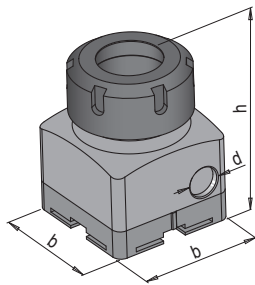

| b  | h    | d  | N°            | EUR |
|----|------|----|---------------|-----|
| 54 | 70,5 | 13 | HER 1232/ER32 | <>  |