

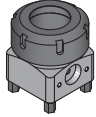





PRODUCT DESCRIPTION

- » Original reference elements
- » Compatible with ITS-50
- » Prepared for chip encoding



| | Content | Pcs. | No. | EUR |
|---|---------------|------|-------------------|-----|
|  | HER 1134/ER40 | 1 | HER 1134/ER40/Set | <> |
|  | HER 1810/ 1 | 1 | | |
|  | Ø 4 | 1 | | |
| | Ø 5 | 1 | | |
| | Ø 6 | 1 | | |
| | Ø 7 | 1 | | |
| | Ø 8 | 1 | | |
| | Ø 9 | 1 | | |
| | Ø 10 | 1 | | |
| | Ø 11 | 1 | | |
| | Ø 12 | 1 | | |
| | Ø 13 | 1 | | |
| | Ø 14 | 1 | | |
| | Ø 16 | 1 | | |
| | Ø 17 | 1 | | |
| | Ø 15 | 1 | | |
| Ø 18 | 1 | | | |
| Ø 19 | 1 | | | |
| Ø 20 | 1 | | | |
| Ø 21 | 1 | | | |
| Ø 22 | 1 | | | |
| Ø 23 | 1 | | | |
| Ø 24 | 1 | | | |
| Ø 25 | 1 | | | |
| Ø 26 | 1 | | | |
|  | Wrench ER40 | 1 | | |
|  | HER 1839/ER40 | 1 | | |



PRODUCT DESCRIPTION

- » Original reference elements
- » Compatible with ITS-50
- » Prepared for chip encoding

MATERIAL

- » 1.2083, hardened

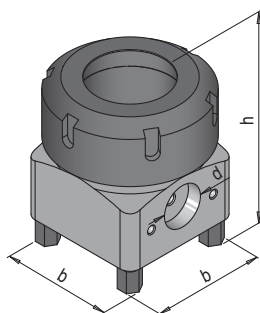

| b | h | d | No. | EUR |
|------|----|----|---------------|-----|
| 52.5 | 81 | 18 | HER 1134/ER40 | <> |