

### PRODUCT DESCRIPTION

» According to VDI 3366

### MATERIAL

» 1.1191  $\approx$  700 N/mm<sup>2</sup>

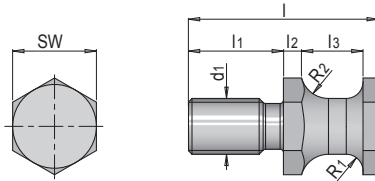

max. kg	SW	l	l1	l2	l3	R1	R2	d1	No.	EUR
320	24	58	28	5.5	20	6	10	M16	E 1280/16	<>
500	30	68	34	6.5	22	6	10	M20	E 1280/20	<>
1,000	36	78	38	8	25	6	10	M24	E 1280/24	<>
1,500	41	95	45	10	32	6	10	M30	E 1280/30	<>
2,500	50	118	56	12	40	8	12	M36	E 1280/36	<>

**i** For safety reasons, always take into account that two supporting lifting studs must carry the weight of the entire die.

